

0.61mm THK COLORBOND®
LCP Hi-END FLASHING

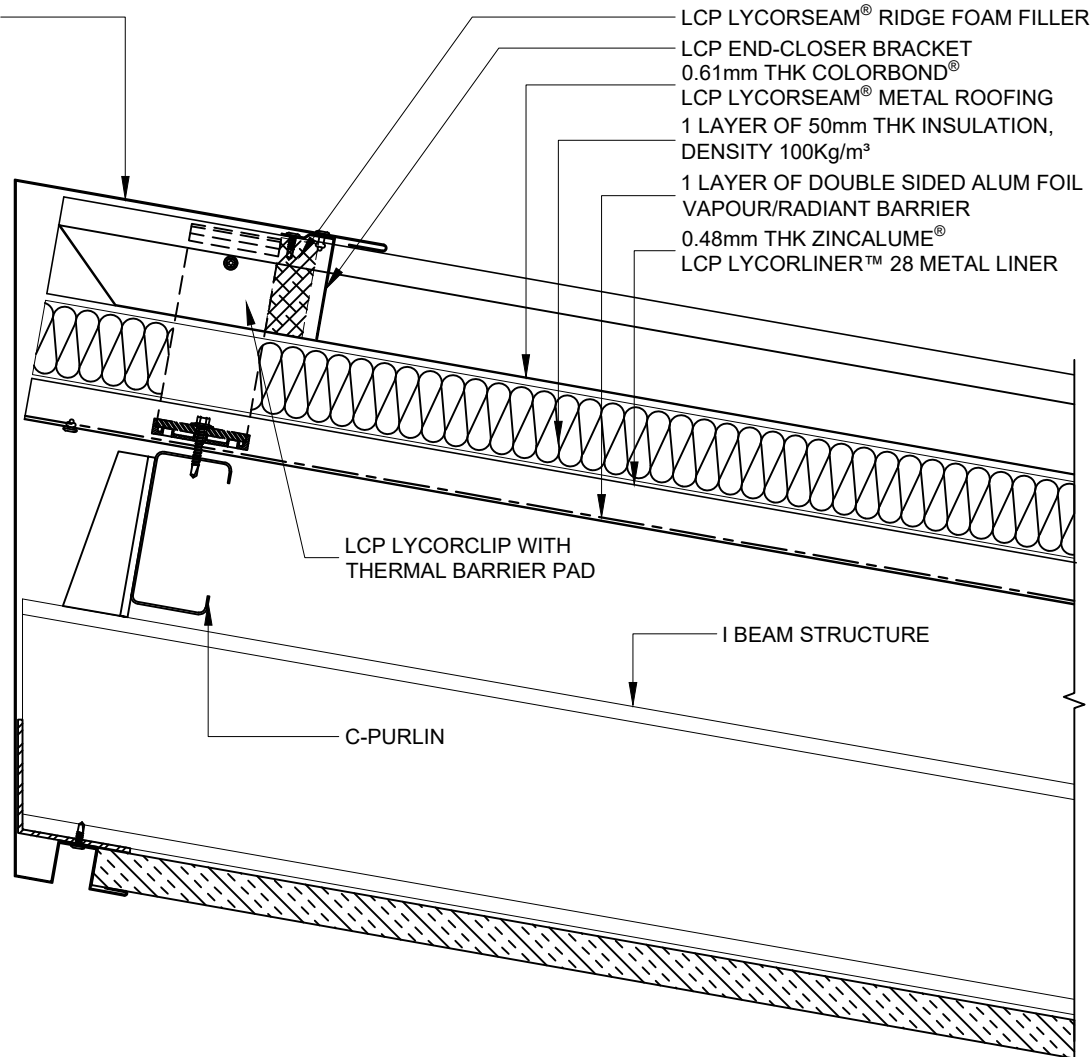

LCP LYCORSEAM® RIDGE FOAM FILLER
LCP END-CLOSER BRACKET
0.61mm THK COLORBOND®
LCP LYCORSEAM® METAL ROOFING
1 LAYER OF 50mm THK INSULATION,
DENSITY 100Kg/m³
1 LAYER OF DOUBLE SIDED ALUM FOIL
VAPOUR/RADIANT BARRIER
0.48mm THK ZINCALUME®
LCP LYCORLINER™ 28 METAL LINER

LCP LYCORCLIP WITH
THERMAL BARRIER PAD

I BEAM STRUCTURE

C-PURLIN



LCP BUILDING PRODUCTS PTE. LTD.

No. 6 Gul Circle, Singapore 629562
Telephone: (65) 6865 1550 Facsimile: (65) 6861 4218 Email: lcp@lcp.sg
A member of LCP Group of Companies (CO. No. 200009173C)

| REV | ISSUES/REVISIONS | DATE | BY |
|-----|------------------|------|----|
| | | | |
| | | | |
| | | | |

—COPYRIGHT RESERVED THIS DRAWING AND DESIGN IS AT ALL TIMES THE PROPERTY OF LCP—BUILDING PRODUCTS PTE. LTD. AND CANNOT BE USED WITHOUT LCP—BUILDING PRODUCTS PTE. LTD. WRITTEN CONSENT.
—ALL DIMENSIONS MUST BE CHECKED BY THE CONTRACTOR BEFORE CONSTRUCTION.
—THIS DETAIL DRAWING IS PURELY INDICATIVE AND IS A CONCEPTUAL DESIGN ONLY. ALL DESIGN MUST BE CHECKED BY LCP—BUILDING PRODUCTS PTE. LTD. TECHNICAL DEPARTMENT. PLEASE NOTE THIS DETAIL IS NOT A FINAL DESIGN AND CANNOT BE USED UNLESS AUTHORISED BY LCP—BUILDING PRODUCTS PTE. LTD..

| | | |
|---|----------------|-----------------|
| PROJECT: LCP LYCORSEAM STANDARD DETAIL | | |
| DRAWING TITLE: HIGH-END FLASHING DETAIL | | |
| DWG. BY: BC | DATE: NOV 2017 | PROJECT NO.: |
| CHKD. BY: JL | SCALE: N.T.S. | SHEET: 15 OF 38 |